

THE WORLD'S FIRST FLEXIBLE WINDOW SCREEN

Begin by opening or tilting both sashes of your window toward the inside of the house to expose the window screen track. Wrap your hands around FlexScreen's longest sides, squeeze the sides together 4"-6", and feed it completely through the window opening.

STEP 1

While keeping the sides compressed, aim FlexScreen's first corner to one of the top corners of the window screen track and seat it into the track.

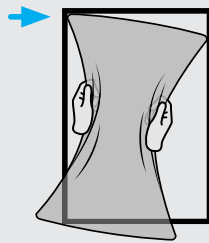

STEP 3

Keeping both sides squeezed together, insert FlexScreen into one of the bottom corners. It may help to lift slightly if your window has a lip on the sill. Release this side of the screen once it has been seated.

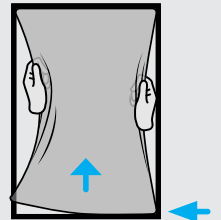

STEP 2

Aim the second corner to the opposite top corner of the window screen track and guide it into the track.

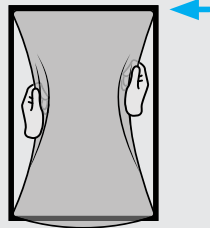

STEP 4

Aim FlexScreen's last corner into the remaining corner of the screen track. Lifting slightly may be helpful for this step as well. Release FlexScreen completely once all corners are seated properly.

Close your window and enjoy your completely uninterrupted view!

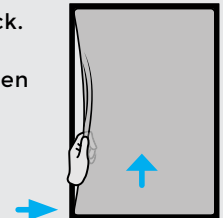



FULL-SCREEN REMOVAL GUIDE

THE WORLD'S FIRST FLEXIBLE WINDOW SCREEN

Begin by opening or tilting both sashes of your window toward the inside of the house to expose the window screen track.

STEP 1

Gently press the palm of your hand in the center of the screen until you can wrap your hands around the FlexScreen frame. Squeeze both sides inward 4"-6".

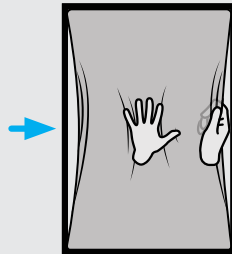

STEP 2

While keeping the sides compressed, lift up the FlexScreen and remove one of the bottom corners from the screen track.

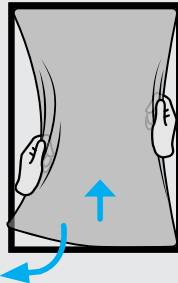

STEP 3

Remove the opposite bottom corner from the screen track.

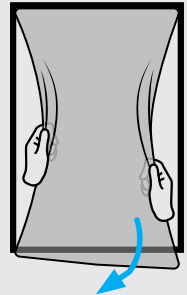

STEP 4

With both corners out of the screen track, pull FlexScreen down from the top screen track and remove the screen.

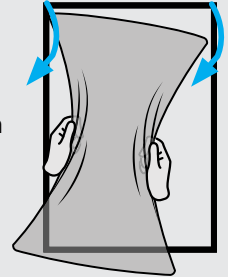

CONTACT US TODAY: flexscreen.net

▶ Visit our website to watch FlexScreen in action